



Federal Board of Intermediate and Secondary  
Education HI-8/4, Islamabad  
(Ph: +92-51-9269538- Ext- 214)



No. FBISE-115756-00031/173

May 23, 2024

**CORRIGENDUM**

**TENDER NOTICE**

Sealed tenders (One Stage one envelope) are invited for Civil Work for Up-Gradation of IMCB I-8/3, Islamabad as per tender documents.

2. The Interested firms registered with Pakistan Engineering Council (PEC) and Income Tax, Sales Departments and are on Active Tax Payers List (ATL) of FBR may quote the rates of the tenders on e-PADS (Mandatory) and in sealed cover envelope duly inscribed as under:-

**“CIVIL WORK FOR UP-GRADATION OF IMCB I-8/3, ISLAMABAD”**

3. Tender documents containing terms and conditions for Civil Work for Up-Gradation of Islamabad Model College for Boys, I-8/3, Islamabad above said tender documents can be collected from the Assistant Secretary (Estate), FBISE on any working day during office hours (9:00 Am to 3:00 PM). Fee Challan can be printed from [www.fbise.edu.pk](http://www.fbise.edu.pk) and submitted in any branch of HBL for tender document is Rs.2000/- (Rupees two thousand) (non-refundable).

4. The sealed tender(s) document along with earnest money which is 5% of the total contract amount shall be submit on e-PADS (Mandatory) and hardcopy in the FBISE before 31-05-2024 at 02:00PM. Tender will be opened on **same day** at 02:30PM in presence of tenderer/representatives.

5. This advertisement is also available on PPRA and FBISE's websites. The bidders are requested to frequently visit the websites for any updates/amendments.

  
**(DR. BASHIR KHAN YOUSAFZAI)**  
**SECRETARY**  
**Ph: 051-9269502**





Federal Board of Intermediate and Secondary  
Education HI-8/4, Islamabad  
(Ph: +92-51-9269538- Ext- 214)



**CORRIGENDUM**

**TENDER FOR CIVIL WORK FOR UP-GRADATION OF IMCB I-8/3,  
ISLAMABAD**

Name of Work	Estimated Cost (PKR)	PEC Cat:	Anticipated Time of Work
Civil Work for Up-Gradation of IMCB I-8/3, Islamabad	30.00 Million	Min-C-5	02 Months

Detail of Work	Pages
Cover Page	01-02
Tender Notice/ Publication Letter	03-04
Terms & Condition for the Submission of Tender	05-06
Contract Agreement	07-08
Bill of Quantities (BOQ)/Summary of Cost i. Civil Work ii. Electrical Work	09-22
Drawings	23
<b>Total Pages</b>	<b>23</b>

  
Shahab-Ud-Din  
Deputy Secretary (Estate)  
Phone# 051-9269538



Federal Board of Intermediate and Secondary  
Education H-8/4, Islamabad  
(Ph: +92-51-9269538- Ext- 214)



No. FBISE-115756-00031/173

May 23, 2024

Deputy Director III (PPRA)  
Public Procurement Regularity Authority  
(Cabinet Division)  
F.B.C. Building G-5/2,  
ISLAMABAD

**SUBJECT: PUBLICATION OF CORRIGENDUM TENDER NOTICE ON PPRA'S WEBSITE**

Dear Sir,

Corrigendum Tender Notice for "Civil Work for Up-Gradaation of IMCB I-8/3, Islamabad" is enclosed for the advertisement against TS539667E.

2. You are, requested to advertise the tender Notice, on PPRA's Website as required vide Rule 12 of the Public Procurement Rules 2004.
3. Subsequent to advertisement of the tender notice, bill may please be forwarded to this office for payment, please.
4. In Case of any quarry please contact us at Phone number 051-9269538.

Yours faithfully,

(DR. BASHIR KHAN YOUSAFZAI)  
SECRETARY  
Ph: 051-9269502



Federal Board of Intermediate and Secondary  
Education H-8/4, Islamabad  
(Ph: +92-51-9269538- Ext- 214)



No. FBISE-115756-00031/73

May 23, 2024

**CORRIGENDUM**

**TENDER NOTICE**

Sealed tenders (One Stage one envelope) are invited for Civil Work for Up-Gradation of IMCB I-8/3, Islamabad as per tender documents.

2. The Interested firms registered with Pakistan Engineering Council (PEC) and Income Tax, Sales Departments and are on Active Tax Payers List (ATL) of FBR may quote the rates of the tenders on e-PADS (Mandatory) and in sealed cover envelope duly inscribed as under:-

**“CIVIL WORK FOR UP-GRADATION OF IMCB I-8/3, ISLAMABAD”**

3. Tender documents containing terms and conditions for Civil Work for Up-Gradation of Islamabad Model College for Boys, I-8/3, Islamabad above said tender documents can be collected from the Assistant Secretary (Estate), FBISE on any working day during office hours (9:00 Am to 3:00 PM). Fee Challan can be printed from [www.fbise.edu.pk](http://www.fbise.edu.pk) and submitted in any branch of HBL for tender document is Rs.2000/- (Rupees two thousand) (non-refundable).

4. The sealed tender(s) document along with earnest money which is 5% of the total contract amount shall be submit on e-PADS (Mandatory) and hardcopy in the FBISE before 31-05-2024 at 02:00PM. Tender will be opened on same day at 02:30PM in presence of tenderer/representatives.

5. This advertisement is also available on PPRA and FBISE's websites. The bidders are requested to frequently visit the websites for any updates/amendments.

**(DR. BASHIR KHAN YOUSAFZAI)**  
**SECRETARY**  
**Ph: 051-9269502**



Federal Board of Intermediate and Secondary  
Education H-8/4, Islamabad  
(Ph: +92-51-9269538- Ext- 214)



**TERMS AND CONDITIONS FOR THE SUBMISSION OF TENDERS**

1. The firms registered with Pakistan Engineering Council and on Active Taxpayer list (ATL) of FBR and e-PADS (e-Pak Acquisition and Disposal System) on PPRA are eligible to participate in the tender.
2. Tenders must be sealed and addressed to the Secretary, Federal Board of Intermediate & Secondary Education, H-8/4, Islamabad. Unsealed Tenders are liable to be rejected. Conditional Tender shall not be entertained.
3. The word **Tender for Civil Work for Up-Gradation of IMCB I-8/3, Islamabad** must clearly be written on top of the envelope.
4. Tenders will be received **upto 31-05-2024** at 02:00 PM and will be opened on the same day at 02:30 PM.
5. Viewing the tender and its completion by e-PADS (e-Pak Acquisition and Disposal System) is facilitating on PPRA website.
6. The filing & submission of tender is necessary in hard copy and also on e-PADS (e-Pak Acquisition and Disposal System).
7. No tender will be accepted without earnest money @ Rs. 5% of total amount of any schedule Bank drawn in favour of the Secretary, Federal Board of Intermediate & Secondary Education, H-8/4 Islamabad which will be refunded after 03Months of the successful completion of job.
8. The earnest money will be forfeited if the tenderer fails to honor his quoted rates, or if he does not abide by other terms and conditions of the job.
9. The successful party will have to sign an agreement on a judicial paper having stamp of notary public worth Rs. 100 (Rupees one hundred only) to be purchased by the tenderer.
10. The Tenderer shall also have to complete the job within 02Months on fast track as per agreed schedule no extension will be granted. In case of delay, deposited earnest money will be forfeited.
11. All applicable taxes will be deducted at source as per Government Rules.
12. In case of any dispute the Chairman of the Federal Board shall be the final authority to give decision.

**Note:** The Tenderer shall quote the rates of items corresponding to the specification mentioned in the Tender document only.

(DR. BASHIR KHAN YOUSAFZAI)  
SECRETARY  
Ph: 051-9269502

Name of Firm \_\_\_\_\_ Address \_\_\_\_\_  
NTN No. \_\_\_\_\_ Contact No. \_\_\_\_\_  
Date. \_\_\_\_\_ Signature & Stamp \_\_\_\_\_

ٹینڈر شرائط برائے اپ گریڈیشن اسلام آباد ماڈل کالج فار بوائز آئی ایٹ تھری، اسلام آباد

شرائط درج ذیل ہیں۔

- i. کام کے دوران کچرے اور ویسٹ میٹریل کو کالج ہڈا کی بلڈنگ سے دور کسی مناسب جگہ ضائع کرنا متعلقہ کنٹریکٹر کے ذمے ہوگا۔
- ii. کام کے دوران سائٹ کے پاس اضافی کچر اور سامان رکھنے کی اجازت نہیں ہوگی اور صفائی کا کام ساتھ ساتھ کرنا ہوگا۔
- iii. میٹریل کی سپلائی کالج اوقات کار کے بعد کرنا ہوگی۔
- iv. مندرجہ بالا تمام کام زیادہ افرادی قوت کو استعمال میں لا کر 2 ماہ کے اندر اندر ہر حال میں پایہ تکمیل تک پہنچانا ہے۔ کسی بھی عذر کی بنا پر کوئی اضافی وقت نہیں ملے گا۔
- v. مختلف نوعیت کے کام ایک ہی وقت میں متوازی شروع کروانے ہونگے اور دن رات جاری رکھنے ہونگے۔
- vi. مجاز افسر کو BOQ کی مقدار میں کمی پیشی کرنے کا اختیار ہوگا۔

ڈپٹی سیکرٹری (اسٹیٹ)

فیڈرل بورڈ اسلام آباد

فون نمبر: 051-9269538

## DRAFT OF AGREEMENT

This agreement is made on \_\_\_\_\_-2024 between Secretary Federal Board of Intermediate and Secondary Education, Islamabad for the 1<sup>st</sup> party (Hereinafter called the Board) and M/S \_\_\_\_\_ (Hereinafter called the Contractor) or the 2<sup>nd</sup> party. Whereas the F.B.I.S.E., Islamabad is desirous Civil work for Up-Gradation of Islamabad Model College for Boys, I-8/3, Islamabad, Islamabad and has accepted the tender submitted by the contractor for the execution of said work. Now this agreement witness as follows:-

2. In this Agreement works and expressions shall have the same meaning as are respectively assigned to them in the conditions of Contract hereinafter referred to.

3. The following documents for the purpose of identification have been signed by Mr. \_\_\_\_\_ S/O \_\_\_\_\_ CNIC No. \_\_\_\_\_ on behalf of M/S \_\_\_\_\_ and Secretary Board on behalf of all of which shall be deemed to firm and be read and constructed as part of this agreement, viz.

- A. The said Quotation/ Tender
- B. The Drawing Specifications.
- C. The Bill of Quantities.
- D. Terms & Conditions.

4. The Contractor undertakes to complete the job according to the specifications, assigned/ shown to the contractor within 02Months after the receipt of work order/Agreement. In case of delay the Chairman reserves the right to impose a penalty each day of delays @ Rs. 1% to 10% (for 10 days 2%, for 20 days 4%, for 30 days 7% above 30 days 10%) of the amount of incomplete work.

5. If the work is not done according to the satisfaction of the Board, the Chairman shall have the right to cancel the order and get the work done by some other party at the cost and risk of the contractor. If the Board has to pay any amount excess of the agreed amount the difference shall be recovered from the contractor.

6. If the work is not executed according to the satisfaction of the 1<sup>st</sup> party, the Chairman reserves the right to reject altogether or impose a penalty not exceeding 50% of the amount of contract.

7. The contractor will replace any item not found according to the specifications at any time during the use of the same at his own cost, failing which the earnest money shall be forfeited. In addition, the Chairman may impose any penalty, deemed fit for the inconvenience, caused to the Board.

8. The payment would be made in accordance with the actual measurements to be calculated after the completion of work.

9. The Contractor shall not claim any amount beyond the work order/ tender as settled between the parties.

10. In case of any dispute between the parties arising out of this contract, the same shall be referred to the Chairman Federal Board of Intermediate and Secondary Education Islamabad as sub arbitrator, whose decision shall be final and binding on both the parties.

11. The payment would be made as per following sequence:

The each bill will not less than 3 Million as per BOQ rate duly verified as per actual measurement on site duly verified sub Engineer.

12. The contractor undertakes to carry out 15% additional work as per PPRA rules on same rates if required by this office.

13. At any cost no advance payment will be requested by the contractor.

**IN WITNESS WHERE** of the parties hereto have hereunto set their respective hand and seals the day and year first above written.

Signed Sealed and Delivered by the:

**Federal Board of Intermediate and Secondary Education, H-8/4, Islamabad**

**SECRETARY  
(FBISE, ISLAMABAD)**

Witness by 1<sup>st</sup> Party  
Abdul Razzaq Khan  
Assistant Secretary (Estate)

\_\_\_\_\_ S/O \_\_\_\_\_  
CNIC: \_\_\_\_\_  
For and on behalf of Contractor  
M/S \_\_\_\_\_

Witness by 2<sup>nd</sup> Party  
Signed by  
\_\_\_\_\_ S/O \_\_\_\_\_  
CNIC: \_\_\_\_\_





Federal Board of Intermediate and Secondary  
Education H-8/4, Islamabad  
(Ph: +92-51-9269538- Ext- 214)



**CORRIGENDUM**

CIVIL WORK FOR UP-GRADATION OF IMCB I-8/3, ISLAMABAD		
SUMMARY OF COST		
S.No.	DESCRIPTION	AMOUNT Rs.
1.	Civil Work	
2.	Electrical Work	
TOTAL COST		
Total Amount in Words:		

**IMPORTANT INSTRUCTION: -**

1. Enclose copy of GST Registration/ Sales Tax.
2. Incomplete tender documents shall not be entertained/ included in the competition.
3. Tampered or overwritten rates are not acceptable.
4. Enclose Copy of Experience/completion Letter of the same nature project.

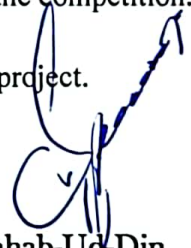
  
Shahab-Ud-Din  
Deputy Secretary (Estate)  
Phone# 051-9269538

1. Bidder's Income Tax No. \_\_\_\_\_ 2. Earnest money 5% of Total amount  
Rs. \_\_\_\_\_ 3. Bank Draft No. \_\_\_\_\_ dated \_\_\_\_\_

*I shall abide by the terms & conditions of the tender documents*

Name \_\_\_\_\_ Phone# \_\_\_\_\_  
Address \_\_\_\_\_

**SIGNATURE & SEAL OF THE FIRM**



**Federal Board of Intermediate and Secondary  
Education H-8/4, Islamabad**

(Ph: +92-51-9269538- Ext- 214)



**TENDER FOR UP-GRADATION OF IMCB I-8/3, ISLAMABAD**

Sr. #	DISCRIPTION	APPROXIMATE MEASUREMENT	RATE	AMOUNT
<b>CIVIL WORKS</b>				
	<b><u>SCRAPING/ REMOVAL</u></b> a) Dismantling of concrete, brick work and disposal of all waste material from the site. b) Removal of old Door & Chowkat on any floor etc stacking of useable material and disposal of all waste material. c) Scraping/removal of old plaster where damage and disposal of all waste material. d) Disposal of existing waste material from ground to five mile away.	1000 CFT 50 NOS 3000 SFT 15 Trolley		
	<b><u>P.C.C. (1:4:8) UNDER FLOOR</u></b> Providing, and laying cement concrete not leaner than (1:4:8) using screened crushed stone graded aggregate 3/4 inch (19 mm) and sand from approved source in foundations, including form work and its removal, compacting, levelling and curing etc. complete as directed by the Engineer Incharge.	4800 CFT		
	<b><u>P.C.C. (1:2:4)</u></b> Providing, and laying cement concrete not leaner than (1:2:4) 2" to 3" thickness using screened crushed stone graded aggregate 3/4 inch (19 mm) and sand from approved source in foundations, under floors having a minimum cylinder crushing strength of 20 Mpa at 28 days including form work and its removal, compacting, levelling and curing etc. complete as directed by the Engineer Incharge	700 CFT		

	<p><b><u>TUFF TILES</u></b>          Providing and fixing of glazed finished best quality Tuff Tiles (1'x1') with 2" average mortar (1:5) ratio in different colour Pattern and cement color grouting complete in all respects</p>	13000 SFT		
	<p><b><u>FACE BRICK (GUTKA)</u></b>          Providing and fixing of fair face brick (gutka) cladding with cement mortar, surkhi with sufficient water to produce proper consistency (1:4) on front wall after scarping of painted surface, curved, arches on round window, coulumn, beams as per existing shape/design in yellow colour Pattern as approved including the cost of supporting iron ingles on window arches, curved curing and cost of scaffolding, fixing complete in all respects directed by Engineer</p>	5200 SFT		
	<p><b><u>MARBLE ON STAIRS</u></b>          Providing and fixing best quality pre-chemical polished marble slabs of 3cm thick on treads of approved colour and best quality on stairs, with under coat (1:3) cement sand mortar bed including making of nosing, cutting, grinding and , complete in all respects, as per drawing or as directed by the Engineer Incharge.          a. Treads          b) Risers</p>	600 SFT 300 SFT		
	<p><b><u>FIBER SHADE</u></b>          Providing and fixing of 3 ply fiber 14' height using 1"x1" iron pipe frame, 9inch qanchi for sport, 14 SWG sported MS pipes 4" dia fixing on the (4") base plate with riveting and complete enamel paint on structure complete in all respects</p>	8200 SFT		
	<p><b><u>FLOOR TILES</u></b>          Providing and fixing glazed ceramics tiles grade A in approved shade &amp; colour (2'x2') China Times/Orial or as approved equivalent) laid over 3/4" (19mm) thick with tiles bond best quality including fixing and jointing, with</p>	3000 SFT		

	colour grout mix and curing etc. Complete in all respects, as per drawing or as directed by the Architect /Engineer Incharge.			
	<b><u>TILES SKIRTING</u></b> Providing & fixing of 24"x4" glazed tile skirting with tiles bonds	2500 RFT		
	<b><u>FALSE CEILING</u></b> Providing & fixing of imported gypsum sheet (600mm x 600mm) including aluminum Tee, aluminum angle, hanger clips and GI wire etc complete imported China fitting.	4000 SFT		
	<b><u>POP FALSE CEILING</u></b> Providing & fixing of POP false ceiling with 4sutter POP sheet including the cost of wire and patsun in different approved design for labs	5000 SFT		
	<b><u>VINYAL FLOORING TILES</u></b> Providing and fixing of scratch resistant vinyl flooring tiles as approved shade & colour (2'x2') Complete fixing in all respects, as per drawing or as directed by the Architect /Engineer Incharge.	11000 SFT		
	<b><u>CERAMIC TILES (WASHROOM)</u></b> Providing and fixing glazed ceramics tiles grade A in approved shade & colour (1'x2') China Times/Oriel or as approved equivalent) laid over 3/4" (19mm) thick with tiles bond best quality including fixing and jointing, with colour grout mix and curing etc. Complete in all respects, as per drawing or as directed by the Architect /Engineer Incharge.	5000 SFT		
	<b><u>BRICK MASONRY FOR PARTITION WALLS</u></b> <b><u>D) 9"~ 13.5" THICK WALLS</u></b> a. Providing and laying first class solid burnt brick masonry, set in cement mortar (1:5) for arches in straight or curved wall 9"to 13 ½" (229mm to 343mm) thick including scaffolding, formwork and its removal, racking	5000 CFT		

	<p>out joints and curing etc. including the cost of L shape bracket on every 8<sup>th</sup> course complete in all respect or as directed by the Engineer in charge.</p> <p>b. Same as part a but with the using of old available bricks on site for sitting stair excluding the cost of bricks</p>	2000 CFT		
	<p><b><u>RCC SLAB</u></b>          Providing and fixing of readymade concrete slab with concrete girders for roof with cement concrete and mortar complete in all respect including grouting</p>	700 SFT		
	<p><b><u>PLASTER</u></b>          Providing 13mm thick cement plaster (1:4) on soffits of cantilever slabs, sides and soffits of beams, slabs R.C.C and brick walls (using Lawrence pur sand) etc., in any floor including making edges, corners, curing staging and scaffolding etc. including cost of Providing and fixing chicken mesh with nails over all joints of walls with columns, beams and slab, complete as directed by the Engineer Incharge.</p>	5700 SFT		
	<p><b><u>MS / STEEL CHOWKATS</u></b>          Supply and fix steel frame (chowkats) press moulded 16 SWG for 10 inch thick walls complete including hold fasts, and bitumen coating ties for lateral movement P.C.C strength of (10 Mpa) caving filling etc. or as directed by the Engineer Incharge.</p>	280 RFT		
	<p><b><u>SOLID WOODEN (PANEL) DOORS</u></b>          Providing and fixing 1-1/2" thick solid panel doors with Malaysian ply 3mm thick on both faces of deodar wood shutter frame 1-1/4" thick and partial wood braces at 3 " apart and deodar wood lipping beading 1-1/2" x 3 /8" thick of best quality including cost of approved Bronze /stainless steel hinges, looking glass panel 12"x 9 "etc. including three coats of mat enamel paint/glazes Polish as required and</p>	350 SFT		

	<p>covered with 22 gauge aluminum (10cm) high kick plate fixed with screws including door lock, hydraulic door closer of best quality, stopper , latch and push plate,10cm c/c on both side, bottom rail of 22SWG and stainless steel 150x50x6 mm finger plates with aluminum screw, approved quality or as directed by the Architect /Engineers in charge.</p>			
	<p><b><u>WOODEN DOOR</u></b>          Providing and fixing 2 inches (50mm) thick best quality seasoned solid dayar/sheesham/teak wood doors embossed design on both sides double tharri doors shutters fully paneled with same wood with brass/stainless steel hinges and tower bolts etc as required complete including cost of handles and best quality same wood chowkat 13.5"x 2" (34cm x5cm)wooden architrave (75mm x25mm) on both sides, including 8 No's M.S (6"x2"x1/8") hold fast in P.C.C (1:2:4) including filling around the chowkat complete in all respects as per drawing technical specifications, beautiful design pattern with grinding and polishing as complete directed by the engineer incharge.</p>	<p align="center">110 SFT</p>		
	<p><b><u>WOODEN TABLE</u></b>          Making of wooden table with lamination Sheet(colored), wooden frame, sheesham Gola and UPVC design lamination sheet for Top of labs different sizes complete in all respect</p>	<p align="center">1500 SFT</p>		
	<p><b><u>REPAIR OF CHAIRS</u></b>          Repair of student chair back strip          Repair of student writing arms strip          Complete enamel paint of ICI/Nippon OR equivalent on chairs after filling crack and poteen etc complete in all respect</p> <p>    a. Large size chair              b. Small Size chair              c. Large size desk              d. Small size desk</p>	<p align="center">400 NO          100 NO</p> <p align="center">600 NO          150 NO          150 NO          150 NO</p>		

	<b><u>WOODEN POLISH</u></b> Grinding and polishing of old wooden paneling with high quality lacquer polish complete in all respect	3200 SFT		
	<b><u>ALUMINUM GLASS DOOR</u></b> Providing and fixing of 2mm aluminum door with 5mm plain glass with machine, handles, lock, hinges and door closer complete in respect	250 SFT		
	<b><u>WOODEN ALMIRAH</u></b> a) Making of wooden Almirah With Lamination Sheet(colored) , sheesham Gola, Handles, Lock on every door hydraulic hangs etc almirah depth 16" of different sizes complete in all respect b) Making of wooden Rack With Lamination Sheet, rack depth 16" of different sizes complete in all respect	200 SFT  200 SFT		
	<b><u>GLASS DOOR</u></b> Providing and fixing of 12mm glass frosted design door with machine, handles, lock, hinges and door closer complete in respect approximate size 4'x7'	02 NOS		
	<b><u>SPD EMULSION</u></b> Painting with (ICI/Berger Robbaliac/Nippon or approved equivalent) SPD emulsion paint of approved shade (Multi colors) two coats over primer applied over putty filled surface prepared with sand papering including the cost of one priming coat complete in all respect already painted surface on walls and ceiling etc. at any height and any floor or as directed by the Engineer Incharge.	70000 SFT		
	<b><u>WEATHER SHIELD</u></b> Painting three coats of weather shield paint (ICI/Berger /Nippon or approved equivalent) of approved shade (Multi colors) on plastered surface (external) including the cost of clearing the surface, sand papering etc projection soffits	70000 SFT		

	complete upto at any height in any floor or as directed by the Engineer Incharge.			
	<b><u>ENAMEL PAINT</u></b> Painting with (ICI/Berger Robbaliac/ Nippon or approved equivalent) mat enamel paint of approved shade(multi colors) two coats over surface prepared with sand papering complete in all respect over plastered surface on walls and ceiling etc. at any height and any floor or as directed by the Engineer Incharge.	25000 SFT		
	<b><u>POLISH</u></b> Grinding and polishing of old chips floor and marble stair with grinding and chemical polish after filling cracks complete in all respect	16500 SFT		
	<b><u>NAME BOARD</u></b> Making and fixing of stainless steel word of "ISLAMABAD MODEL COLLEGE FOR BOYS I-8/3 ISLAMABAD" approximate size 3feet of words on front gutka wall complete fixing of all respect	1 JOB		
	<b><u>SIGN BOARD</u></b> a) Making and fixing of iron sheet sign boards on iron pipe 2" fixing in ground with concrete approximate size 8'x3' b) Making of 8mm glass wall mounted name plates with brackets including the cost of printing stickers as approved size 18"x18" c) Same as b) size 12"x12"	05 NOS  05 NOS  10 NOS		
	<b><u>PVC PANELING</u></b> Providing and fixing PVC (hard type best quality) wall paneling as approved design or color complete in all respect	3000 SFT		
	<b><u>CARPET</u></b> Providing and fixing of artificial grass carpet best quality indoor/ outdoor as per site	2500 SFT		
	<b><u>KERB STONE</u></b> a) Providing and fixing of 16" concrete curved kerb stone on loan boundaries with 1:2:4 concrete base b) Same as a) size 12 inch	1200 RFT  1250 RFT		



	<p><b><u>PLANTS FOR FRONT AREA</u></b>  i- Pine tree 8 feet height  ii- Aero Caria 5 feet height  iii- Silver Oaks 8 feet height  iv- Different type of outdoor plants with planter size 14 in planter (multi colors planters with enamel paint)</p>	<p>25 NOS  25 NOS  25 NOS  100 NOS</p>		
	<p><b><u>EXCAVATION</u></b>  Excavation in all kind of soil normal, boulder, soft and hard rock upto required depth for foundation and etc. and stacking of excavated material clear of edge of excavation, after excavation leveling and compaction test, including timbering shoring if required, back filling in layers and dewatering &amp; compaction as specified including stacking the serviceable materials and disposal of useless material any lead and lift with in project as per drawings, technical provisions and instructions of the engineer incharge.</p>	<p>1500 CFT</p>		
	<p><b><u>CRUSH</u></b>  Providing and laying of crush mix and down size for walking track etc</p>	<p>1000 CFT</p>		
	<p><b><u>BACK FILLING</u></b>  Back filling with mixture of soil, Rocks or stone in sitting stair for ground including curing, compacting leaving complete</p>	<p>2000 CFT</p>		
	<p><b><u>GROUND GRASS</u></b>  Removal of existing grass, leveling off the ground with Rotavator and providing and lying of American grass (carpeted) on the leveled grounds complete in all respect</p>	<p>20000 SFT</p>		
<b>PUBLIC HEALTH WORK</b>				
	<p><b><u>FITTING AND FIXTURES:-W.C</u></b>  Providing and fixing best quality squatting type white glazed earthenware W.C Pan, Pakistani Bright (of not less than 18 Inches clear opening as measured between flushing</p>	<p>25 NOS</p>		

	rims) complete with and including the cost of 13.6 liter best quality low level plastic flushing cistern with internal fittings complete, P.V.C. flushing pipe suitable for squatting type with extra bends and length with fittings, C.I. trap 4 inches (100mm) dia and making requisite number of holes in walls, plinth & floor for pipe connection and making good in cement concrete 1:2:4.			
	<b><u>ENGLISH COMMODE:</u></b> Providing and fixing best quality squatting type white glazed Pakistani Bright English Commode (one Piece) with all connection pipes, P-trap with fitting including the cost of P/F C.P. double bib-cock with Muslim shower (water tap) Sonnex, Faisal including all fittings for complete installation, complete in all respects and as directed by the Engineer Incharge.	07 NOS		
	<b><u>WASH HAND BASIN</u></b> Supply and fix wash hand basin in light colour with pedestal glazed ware 650mm long, one hole complete with waste pipe, coupling, chain and plug, best quality Pak made Shabir, Master or Equivalent fixed to concrete, brick, stone or wood work.	12 NOS		
	<b><u>TOWEL RAIL</u></b> Supply and fix towel rail, chromium plated, single rod any pattern, shape and size Pak made complete with plugs, screws etc fixed to concrete, stone, brick or wood work.	10 NOS		
	<b><u>LIQUID HAND WASH DISPENSER</u></b> Supply and fix Liquid hand wash dispenser.	05 NOS		
	<b><u>SINGLE BIB-COCK</u></b> P/F C.P. single bib-cock Sonnex, Faisal including all fittings for complete installation, complete in all respects and as directed by the Engineer Incharge.	25 NOS		

	<p><b><u>BASIN T-STOP COCK</u></b> P/F basin t-stop cock Sonnex, Faisal including all fittings for complete installation, complete in all respects and as directed by the Engineer Incharge.</p>	20 NOS		
	<p><b><u>MIRROR</u></b> Supply and fix mirror any shape and pattern 5mm thick of sizes, Balgium made edges ground, complete fixed to concrete, brick, stone or woodwork including Aluminum frame and Lasany wood used on the back of the mirror.</p>	150 SFT		
	<p><b><u>FLOOR TRAP</u></b> Providing and fixing C.I. trap with 4 inches (100 mm) dia inlet and 4 inches (100 mm) dia outlet of the approved self-cleansing design with C.I. grating with or without a vent arm including cost of making requisite number of holes in wall, plinth and floor for pipe connection and making good in cement concrete 1:2:4.</p>	25 NOS		
	<p><b><u>GUNMETAL VALVE</u></b> Valves "peets" pattern, strong gunmetal, high pressure, "Fully-way" valve with iron wheel head screwed both ends for iron pipe, 15mm dia, supply and fixing. a) 25mm dia valve b) 40mm dia valve c) 50mm dia valve</p>	10 NOS 03 NOS 03 NOS		
	<p><b><u>INTERNAL DRAINAGE WORKS</u></b> <b><u>UPVC PIPES</u></b> Providing and fixing of Master fit class "B" UPVC approved best quality pipe including sockets, bends, tees etc. complete as approved by Engineer Incharge. a) 75 mm dia b) 160 mm dia</p>	250 RFT 250 RFT		
	<p><b><u>MANHOLE</u></b> Providing manhole type 'A' size 3 feet x 3 feet</p>	05 NOS		

<p>(inside dimensions) x 4 feet deep as per approved design and specifications complete for 4 inches to 12 inches (100 to 305 mm) dia pipes up to 3 feet-11 inches (1.19 m) depth with cast iron cover and frame 16 inches (406 mm) dia, inside (weight=1 Cwt.1 Qtr.) or 63.5 kg. fixed in 4 inches (100 mm) thick RCC 1:2:4 slab, 8 inches (203 mm) thick c.c. 1:3:6 Brick masonry walls set in 1:3 c.m; 6 inches (150 mm) thick 1:3:6 c.c. in foundation 1:2:4 c.c. in benching, 1/2 inches (13 mm) thick cement plaster in 1:3 C.M. to all inside wall surface, channels and benching etc. and to top including making requisite number of main and branch channels, including the cost of excavation back filling and disposal of excavated stuff &amp; manhole cover and frame.</p>			
<p><b><u>PLASTIC GRATING</u></b> Supply and fix plastic grating 100mm x100mm.</p>	25 NOS		
<p><b><u>INTERNAL WATER SUPPLY</u></b> Providing and Laying DADEX 'PPR' pipe with all fittings (i.e. sockets, bends, tees, elbows where required) and laid complete in trenches (exclusive of excavation) or fixed to walls, ceilings and floors etc including caps and plugs as required supply and fixing. a). 25mm dia (Concealed inside) b). 1 inch dia (GI Pipe open)</p>	350 RFT 350 RFT		
<b>TOTAL AMOUNT</b>			
<b><u>ELECTRICAL WORKS</u></b>			
<p><b><u>SMD LIGHTS 2X2 (FEET)</u></b> a) Supply/installation testing and commissioning of SMD Lights 2x2 feet in the fall ceiling &amp; will be connect with the already install light point, using wire 40/.076 OR 3/.029 for each light connection b) Same as a) SMD size round SMD 12 watt</p>	25 NOS  230 NOS		

<p><b><u>SWITCHES &amp; SOCKETS</u></b>  <b><u>SWITCH PLATES</u></b>                  Supply and installation of 10 amps china fitting switch gang plate with appropriate size of back steel box 16SWG two coats of antirust paint fixed recessed in wall including all fixing accessories and of the following types:                  a) 4 gang switch plate                  b) 6 gang switch plate</p>	<p>12 NOS 30 NOS</p>		
<p><b><u>CEILING FANS</u></b>                  Supply, installation, testing and commissioning of ceiling fans, AC capacitor type complete with hanging rod, canopy, blades, nuts and bolts and of specified make including cost of all necessary materials and complete in all respects and of the following sizes: a) 56" Sweep (Copper Winding)                   "Extra GI Pipe/Rod/ size 22" with each fan</p>	<p>15 NOS</p>		
<p><b><u>EXHAUST FANS</u></b>                  Supply, installation, testing and commissioning of exhaust fans of following sizes complete with frame and of specified make including cost of all necessary materials and complete in all respects with all civil works such as dismantling and making good the same as directed by Engineer-in-Charge and also including fly-mesh/louver as approved by Engineer-in-Charge:                  12" dia with metal body copper winding</p>	<p>15 NOS</p>		
<p><b><u>WIRING</u></b>                  Supply of single core stranded copper conductor PVC installed 450/750 volt grade with PVC pipe and duct fitting of the following size.                  7/.029                  3/.029</p>	<p>2000 RFT 2000 RFT</p>		

<b><u>DISMANTLING &amp; RE-INSTALLATION OF CEILING FANS</u></b> Dismantling & Re-installation of Ceiling Fans 56" alongwith included cost of extended GI Road 22" and fan hook wire etc. Note: Fan hock must be fixed with 04 No steel Rawal Bolt.	60 NOS		
<b><u>3 PIN 13 AMPS DOUBLE SWITCH SOCKETS</u></b> Wiring for 3 pin 13 AMP switch Double socket combined unit with 3x single core 2.5mm Sq (7/029) from nearest switch board open wiring with PVC duct Complete in all respect with final testing & commissioning.	10 NOS		
<b><u>LED SEARCH LIGHT</u></b> Providing & fixing of 50wtt LED search lights of multi colours with frame/stand	100 NO		
<b><u>LED ROPE LIGHT</u></b> Providing & fixing of LED Rope Light best quality in POP false ceiling	1500 RFT		
<b>TOTAL AMOUNT</b>			

# Islamabad Model College for Boys, I-8/3, Islamabad

## Ground Floor (Proposals for Construction)

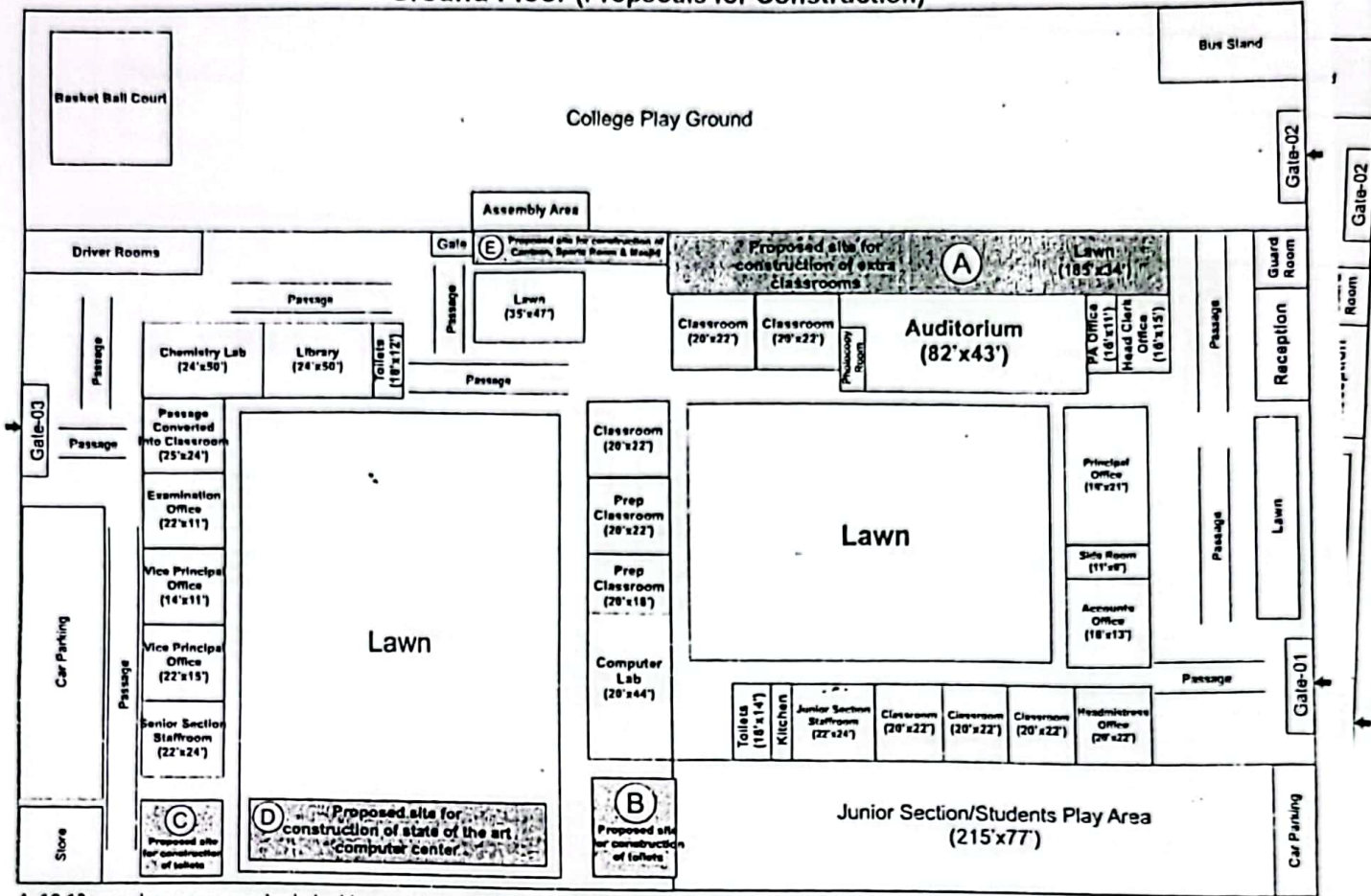

- A. 10-12 new classrooms required, double or triple story block.  
 B. Toilets, 5-6 in number for junior students.  
 C. Toilets, 6-8 in number for senior students.  
 D. A state of the art, multi-purpose Computer/Digital Centre.  
 E. A mosque along with canteen & sports room are also required to be construed.

### First Floor (Layout)

